

## Decoration AND architecture rules

### SIRHA 2017

#### CONTENTS

Paragraph 1	<b>General information</b>  - Obligations for exhibitors and/or stand designers concerning waste disposal	P2
Paragraph 2	<b>Stand construction dossier</b>  2.1 Mandatory elements	P3
Paragraph 3	Specific stand constructions  3.1 Stand split into several islands 3.2 Stand with mezzanine / full ceiling / stand with velum 3.3 Stand floors 3.4 Dressing the hall pillars / posts 3.5 Structures 3.5.1 Floor structures 3.5.2 Hanging structures	P4 P4 P5 P5 P5, P6
Plans	Zones where frame hanging is forbidden	P7
	Plans for ground and hanging structures	P8
Paragraph 4	Reminder concerning the EUREXPO venue	P9
Documents to complete and return	Request for construction of non-outfitted stands	P10, P11
	Request for construction of stands with mezzanine, full ceiling / velum	P12
	Commitment to leave your space in its initial conditions after removing your stand	P13

## 1. General information

This document compiles the rules that apply to the creation and presentation of the stands. They are designed to ensure the smooth running of the event and optimal comfort.

The rules include the standard safety regulations that apply to exhibitions, shows and trade fairs that are mentioned in the Fire Safety Regulation that you must familiarize yourself with.

All stand constructions and decorations must respect:

- The architecture rules
- Fire Safety Regulations
- The PGCSPS (Overall coordination plan for safety and health protection)
- The EUREXPO venue regulations

### **Obligations for exhibitors and/or stand designers concerning waste disposal**

Exhibitors who rent a bare stand (or their stand designer / subcontractor) are responsible for the condition of the rented space and its condition when leaving. In particular they must leave the rented space free of any waste (stand structure elements, boxes, carpets, magazines, flyers, etc.).

**A certificate attesting that you commit to leaving your stand space in its initial state of cleanliness after removal of your stand must be sent to DECOPLUS (SIRHA interior architecture firm) before December 19<sup>th</sup> 2016.**

**(Document available page 13)**

**Note: to rent a skip please contact Eurexpo exhibitors' department:**

**Tel.: +33 (0)4 72 22 30 30**

**Fax: +33 (0)4 72 22 32 32**

**Email: [services@eurexpo.com](mailto:services@eurexpo.com)**

## 2. Stand construction dossier

All **stand construction projects** must be submitted to DECOPLUS - interior architecture firm - that will allow of refuse their assembly at the venue. Projects that fail to comply with the rules will be refused and any stand set up without authorization may be dismantled at the exhibitors' expense.

No agreements between exhibitors are allowed. Only the organisers or DECOPLUS will be authorized to deliver dispensations, and only in response to requests presented in writing.

Stand construction projects must be submitted to DECOPLUS by **December 19<sup>th</sup>, 2016** at the latest.

### Reminder for pre-fitted and outfitted stands:

Any features added to pre-fitted or fully out fitted stands by **contractors other the GL Events** must comply with the architectural rules regarding height, recesses and masking.

All stand construction projects must be submitted to DECOPLUS Architecture Department that will allow of refuse their assembly at the venue.

#### Details for SIRHA architecture firm

DECOPLUS – 13 rue de Fourqueux – 78100 Saint Germain en Laye

Tel: +33 (0)1 47 63 94 84 – Fax: +33 (0)9 57 44 80 92

[w.decoplus@free.fr](mailto:w.decoplus@free.fr)

### 2.1 Mandatory documents to include in your stand construction dossier:

- Bare stand construction form duly completed and signed (P10, P11)
- Floor plan (from above) mentioning the scale, dimensions and positioning of the recesses (common walls + pathways)
- Section plan mentioning the scale, dimensions and height for the planned volumes.



**If the dossier is incomplete, the plans will not be approved and you will not be granted access to EUREXPO.**

### 3. Specific stand constructions

#### 3.1 Stands split into several islands

When a stand is composed of several islands set up on either side of an alley it is possible to build a scenic bridge over the alley under the following conditions:

- No signage and no lighting is allowed over the alleys
- You must order one electrical cabinet (power supply) per island.

#### 3.2 Stand with mezzanine\* / stand with full ceiling / stand with velum

(cf article T23, page 5 'Fire safety regulations')



**\* Construction of stands featuring a mezzanine is subject to reservations and prior approval by GL Events Exhibitions (cf Participation contract)**

Stands with mezzanines are allowed under the following conditions:

- > Stand floor area > 24m<sup>2</sup>
- > mezzanine area limited to 80% of stand floor area with a maximum of 300m<sup>2</sup>
- > Maximum height for the mezzanine: 5 m

**Important:** Stands including a mezzanine must respect a distance of at least 4m from other stands featuring either a mezzanine or a ceiling (type velum), except if two adjoining stands have a mezzanine and that these are placed side by side so as to be considered as a single structure.

a) Exhibitors must prepare their projects, including all plans and load resistance calculation notes, and send them to the Architecture Department of the trade exhibition (who will review the documents for final approval and will forward a copy thereof to the person in charge of safety).

(cf 'Request for construction of stands with mezzanine, full ceiling / velum')

b) An approved firm/body will control the assembly on site in order to deliver a compliance attestation. Without this attestation, the organizer reserves the right to refuse access to the mezzanine to the public.

c) List (non-exhaustive) of approved companies/bodies:

APAVE : 4 rue des Draperies, 69450 ST CYR AU MONT D'OR

Tel : +33 (0)4 72 32 52 52 – Fax : +33 (0)4 37 64 08 00

BUREAU ALPES CONTROLE : 17 avenue Condorcet, 69100 VILLEURBANNE

Tel : +33 (0)4 78 89 73 88 – Fax : +33 (0)4 72 43 98 15

SOCOTEC : 11 rue St Maximin, 69003 LYON

Tel : +33 (0)4 72 11 45 00 – Fax : +33(0)4 72 11 45 67

### 3.3 Stand floors

Stands that feature a raised floor or any type of flooring that entails an elevation equal or **in excess of 2 cm must create one or several inclined sections** in order to allow access to the stands for persons with reduced mobility (cf p9 of the 'specifications list for exhibitors and stand renters').

The standard slope must be 5% maximum for a minimum width of 1 metre.

If this is not possible, 2 cases will be exceptionally allowed as follows:

- > 8% over a length shorter than 2 metres
- > 12% over a length shorter than 0.50 metres

### 3.4 Dressing the hall pillars / posts

Dressing of pillars and posts is allowed up to a height of 5 metres measured from the ground level. Decorations may rest against the pillars but should be separated or insulated using a layer of soft fabric (felt, hardboard, foam...) placed at the point of contact. Any damage will be invoiced to the exhibitor. Important: some pillars / posts are fitted with Fire Hose Reels (cf §4 'Reminder concerning the Eurexpo venue).

### 3.5 Structures (cf plan P9)

#### 3.5.1 Floor structures

**Heights and recess distances are understood as measured from the floor of the building.**

- > Construction height limited to 5 metres, respecting the required recesses, except for:
  - passageways 21/3/34/45/5 limited to 4 metres
  - passageway 22 limited to 2.80 metres
  - gallery 2 limited to 4 metres
  - gallery 4 limited to 3.90 metres
- > Maximum height for stand partition walls: **2.50 metres**

#### Recess distances

Stands constructions must respect the following requirements concerning recess distances:

➤ **Partition walls, height 2.50 m**

> Partitions or construction elements < or equal to 3.00 m set up on alongside the alleys = no recess required with respect to the alleys.

> Partitions or construction elements from 3.00 to 5.00 m set up on alongside the alleys = a distance of 1 m is required with respect to the alleys and to the neighbouring stands.

➤ **Stand construction requirements alley-side / Stand openings facing the alleys**

> Stands that open up onto one or several alleys (stand façades) must not mask more than 50% of their surface opening onto alleys and must not exceed 6.00 m in one uninterrupted stretch. Curtains, veils, frosted adhesives... are not considered as openings. **Only partitions set at half-height will be accepted and with a maximum height of 1.30 m.**

#### Partition walls

Partition walls separating adjoining stands must be smooth, plain, painted in white or covered with white or grey wall fabric **with no type of signage or cables.**

### 3.5.2 Hanging structures (suspended from the framework for the signs / décor structures) SIGNAGE / SIGNS / STRUCTURES

#### Heights

Heights and recess distances are understood as measured from the floor of the building

> **Height of the hanging sign is limited to 6 m** from the ground respecting the required recess distances, except for the following

- |                            |                        |
|----------------------------|------------------------|
| - halls 2.2/2.3/3.2/5.2    | limited to 5 metres    |
| - passageways 21/3/34/45/5 | limited to 4 metres    |
| - passageway 22            | limited to 2.80 metres |
| - gallery 2                | limited to 4 metres    |
| - gallery 4                | limited to 3.90 metres |

> **Maximum height for the signs themselves = 2 metres**

#### Recess distances

> A distance of 1.00 m must be respected with respect to neighbouring stands.

> Stand-alone structures (self-supported) = distance of 1.00 m with respect to the alleys and neighbouring stands. Totems or columns are authorized on both sides of the alleys and over a width of 1.00 m maximum. However, they must not be linked by an overarching banner. Maximum height is 5.00 m

#### Zones where rigging (hanging) is strictly forbidden (see layout on page 7)

- > Gallery 4
- > gallery 2 (over the whole width and over a length of 12 m measured from the Place des Lumières)
- > gallery 6 (over the whole width and over a length of 8.50 m measured from the Place des Lumières)
- > Passageways 21/22/3/34/45/5
- > Passageway between hall 4.1 and hall 4.2B over a width of 15 metres
- > Around the perimeter of most of the halls over a width of 3 metres
- > The centre of Place des Lumières
- > The reception area
- > North footbridge
- > South footbridge



**All projects that require hanging signs/rigging must be subjected to Eurexpo for a feasibility study:**

Contact EUREXPO Prestations suspendues / Rigging

[accrochage@eurexpo.com](mailto:accrochage@eurexpo.com)

Phone: + 33 (0)4 72 22 31 00

ZONE INTERDITES POUR L'ACCROCHAGE EN CHARPENTE – NO RINGGING AERAS

EURI

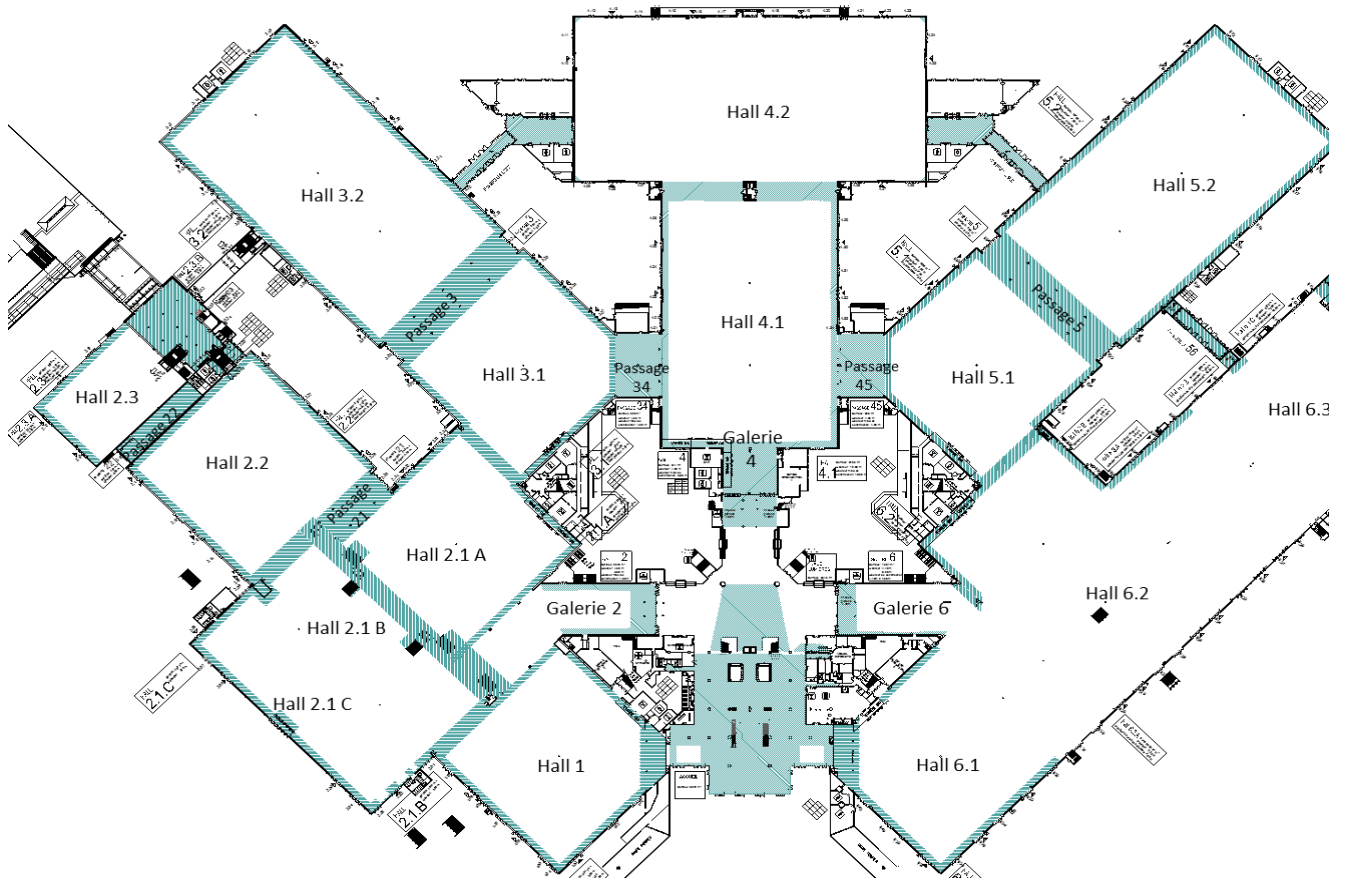





## 4. Reminder concerning EUREXPO venue

### 4.1 Loads accepted on:

- Hall floor: 1.5 tonne/m<sup>2</sup>
- Floor in the Espace Lumière: 500 kg /m<sup>2</sup>
- Floor in the reception area: 500 kg/m<sup>2</sup>

### 4.2 Elevated constructions set against the hall wall:

These are only authorized provided the vertical structures of the halls (steel posts, bracing) are not solicited.

### 4.3 Fire hose reels

- The venue halls are fitted with fire hose reels with 30 m fire hoses
- These reels are fitted onto the central pillars of the halls and next to the emergency exits
- Access to these fire hoses must be cleared at all times over a perimeter of 1m in front and to either side
- Dressing posts/pillars that are fitted with a hose reel is possible only under the following conditions:
  - No elements must overlap onto the hatched area,
  - There must be an opening allowing access to each hose reel (door, curtain, etc.)
  - Signage must be in place next to the accesses to indicate the location of the hose reel.

### 4.4 Doors and gates

Doors and gates must never be cluttered or blocked in any way. They must be operated by the staff in charge of safety.

For information: electric gates are 6 m wide and clearance varies from 4.50 to 8 metres depending on the hall.

### 4.5 Electrical installation for the stands

It is strictly forbidden to use EUREXPO's private technical installations (in particular the technical channels running under the hall floors) to run electrical cables through to the stands.

### 4.6 Access to the halls: Forbidden to all vehicles (except when these are part of the exhibition)

### 4.7 Handling of heavy loads: must be carries out by specialised contractors



It is forbidden to:

- insert screws, paint and/or mark the floor surface
- insert screws, paint, drill holes into the walls, partition walls, posts and pillars.

**REQUEST FORM: CONSTRUCTION OF NON-OUTFITTED STAND**

Requests must be submitted to the Architecture Department by **December 19<sup>th</sup>, 2016** at the latest

**Address of SIRHA 2017 architecture department**

**DECOPLUS – 13 rue de Fourqueux – 78100 Saint Germain en Laye - FRANCE**

**Tel: +33 (0)1 47 63 94 84 – Fax: +33 (0)9 57 44 80 92**

[w.decoplus@free.fr](mailto:w.decoplus@free.fr)

**STAND**

Stand number.....

HALL N°.....

**EXHIBITOR**

Exhibitor's company name.....

Address.....

Post code ..... City.....

Country .....

Name of person in charge of the dossier ..... First name .....

Email ..... Phone.....

Mobile (mandatory).....

Function.....

**If you use the services of a decorator / stand designer:**

Company name of contractor .....

Address.....

Post code ..... City .....

Country.....

Name of person in charge of the dossier ..... First name .....

Email ..... Phone .....

Mobile (mandatory).....

Function.....

**Mandatory documents to attach with this request form:**

- Floor plan (from above) mentioning the scale, dimensions and positioning of the recesses (common walls + pathways)
- Section plan mentioning the scale, dimensions and height for the planned volumes
- Where applicable, the request for authorization to create a stand with mezzanine / full ceiling / velum

The Exhibitor and/or Stand designer:

**1. Hereby declare:**

That we have read and will comply with the dispositions set forth in the following documents:

- Architecture rules and guidelines
- Fire Safety Regulations
- PGCSPPS - Overall coordination plan for safety and health protection

**2. Agree to provide at the venue** (for stands featuring a mezzanine / full ceiling / velum) a certificate delivered by a Technical Control firm attesting to the resistance and stability of the structure.

**3. Agree to fill out and return – before December 19<sup>th</sup> 2016 THE CERTIFICATE ATTESTING WE WILL RETURN THE SPACE TO ITS INITIAL CONDITION** after removal of the stand.



**If the dossier is incomplete, the plans will not be approved and you will not be granted access to EUREXPO venue.**

Signature and stamp of exhibitor and/or  
stand design contractor (mandatory)

AUTHORIZATION REQUEST FOR CONSTRUCTION OF

- Stand with mezzanine       Stand with full ceiling       Stand with velum

Important

- > All stands featuring a full ceiling (including velums using cotton fabric) as defined under articles T22 and T23 of the Fire Safety Regulations **MUST** be approved first, using this form.
- > Requests will be processed in the order they are received and will take into account the dispositions that already apply to the overall installation.
- > **It is imperative that you include with this request:** an installation plan for your stand, calculation notes and the certificates corresponding to the different materials you wish to use.
- > Note: mesh type velums that are Sprinkler-approved do not fall into this category.

**Your contact details**

Company name of exhibitor  
VAT number (ref fiscal law art. 17 2001/11/CE)  
Address

Post code ..... City .....  
Country .....  
Name of person in charge of the dossier ..... First name .....  
Email.....  
Phone ..... Fax.....  
Function.....

Your stand..... Hall N°.....  
Floor surface of the stand  
Surface of the mezzanine  
Surface of the full ceiling  
Type of fabric used

This document must be returned to  
**Service architecture du salon SIRHA 2017**  
**DECOPLUS**  
**13 rue de Fourqueux – 78100 SAINT GERMAIN EN LAYE - FRANCE**  
**Tel : +33 (0)1 47 63 94 84 – Fax : +33 (0)9 57 44 80 92**  
Email : [w.decoplus@free.fr](mailto:w.decoplus@free.fr)

Note: as acceptation is subject to approval by the Safety Committee, additional measures may be requested, at the exhibitor's expense.

